

SLIDE BAR



PULSE

SHOWERS PAS

**Adjustable Slide Bar**

**Model #1010**

**Owner's Manual**



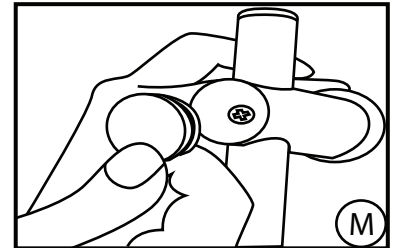
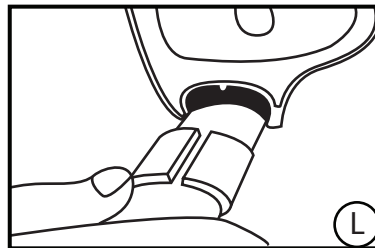
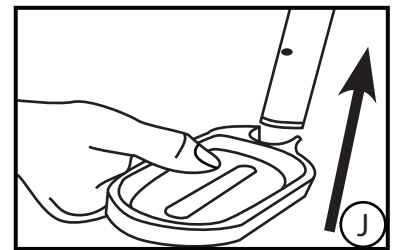
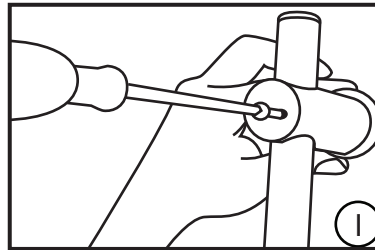
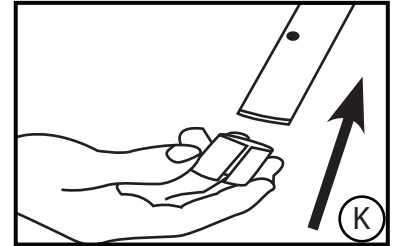
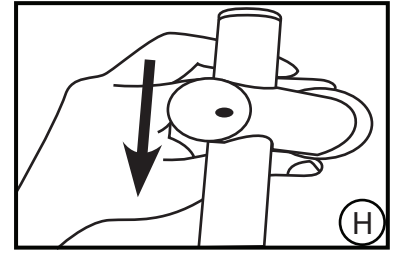
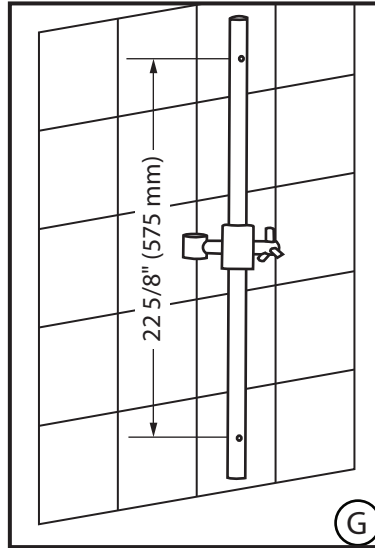
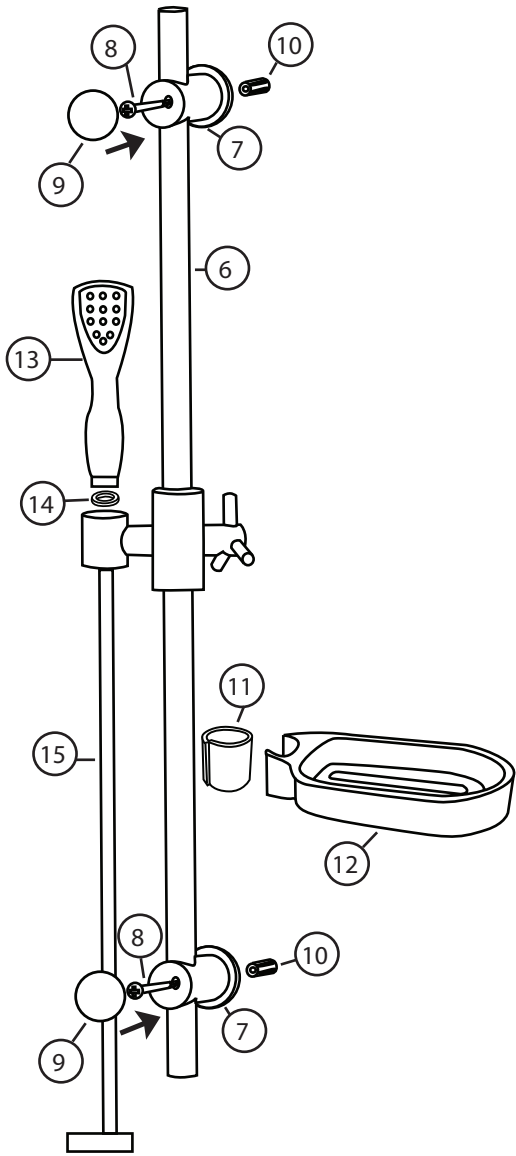

## Adjustable Slide Bar Installation

1. Hold Adjustable Slide Bar (6) in desired mounting location. Evaluate range of adjustment and potential interference of handshower hose (15) (Diagram G).
2. Mark wall for two mounting holes. Before drilling ensure no live plumbing could be damaged.
3. Slowly drill 1/4" (6mm) wide by 1" (25mm) deep holes 22 5/8 inch (575mm) apart. Make sure holes are plumb.

**IMPORTANT:** Supplied anchors are for solid surface only i.e. tile, marble etc. If mounting to hollow or fiberglass wall a different anchor/screw and hole size may be required.

4. Insert wall anchors (10) until flush with wall. Slide top mount (7) over slide bar (Diagram H) and secure with screw (8) (Diagram I).

5. Slide plastic soap dish (12) (Diagram J) onto slide bar followed by narrow end of tapered nylon sleeve (11) (Diagram K). Align tab on soap dish with slot on sleeve and push soap dish down until flush. (Diagram L)

5. Slide lower mount (7) over slide bar and secure with screw (8).

6. Press covers (9) into mounts (7) (Diagram M).

7. Place washer (14) in hex head of hose (15) and connect to diverter outlet. Place washer (14) in smooth end of hose and connect handshower (13). Place handshower into holder.